

BND 600-F

AIR-COOLED MIG GUN

Replacement Suitable for Bernard®

RATING	GUN ORDERING PART NUMBER		GUN PLUG Direct Connect
	Bottom Trigger	Top Trigger	
600 Amp CO2 @ 100% Duty Cycle	B46xx	B46xx-TT	Bernard® Euro Lincoln® "LN" Miller® Tweco® #4 Tweco® #5
	B46xxE	B46xxE-TT	
	B46xxL	B46xxL-TT	
	B46xxM	B46xxM-TT	
	B46xxT	B46xxT-TT	
450 Amp Mixed Gas @ 100% Duty Cycle	B46xxM	B46xxM-TT	
	B46xxW	B46xxW-TT	
Wire Capacity: 0.035" (0.9mm) - 7/64" (2.8mm)	xx = Standard lengths of 10, 12, 15, 20 and 25 ft. Custom lengths also available.		

#	Part Number	Description
1.	B4491	Nozzle - Brass 3/4" I.D.
	B4591	Nozzle - Copper 3/4" I.D.
	B4591HD	Nozzle - Copper, Heavy Duty 3/4" I.D.
	B4492	Nozzle - Brass 9/16" I.D.
	B4495	Nozzle - Brass 5/8" I.D.
	B4592	Nozzle - Copper 9/16" I.D.
	B4592HD	Nozzle - Copper, Heavy Duty 9/16" I.D.
2.	B1589	Contact Tip, Long, .035" 0.9mm
	B1596	Contact Tip, Long, .040" 1.0mm
	B1590	Contact Tip, Long, .045" 1.2mm
	B1598	Contact Tip, Long, .052" 1.4mm
	B1591	Contact Tip, Long, 1/16" 1.6mm
	B1592	Contact Tip, Long, 5/64" 2.0mm
	B1593	Contact Tip, Long, 3/32" 2.4mm
	B1592	Contact Tip, Long, 7/64" 2.8mm
	B7489	Contact Tip, .035" 0.9mm
	B7496	Contact Tip, .040" 1.0mm
	B7490	Contact Tip, .045" 1.2mm
	B7498	Contact Tip, .052" 1.4mm
	B7491	Contact Tip, 1/16" 1.6mm
B7492	Contact Tip, 5/64" 2.0mm	
B7493	Contact Tip, 3/32" 2.4mm	
B7492	Contact Tip, 7/64" 2.8mm	
3.	GT030H	Contact Tip, H.D. Threaded, .030" 0.8mm
	GT035H	Contact Tip, H.D. Threaded, .035" 0.9mm
	GT040H	Contact Tip, H.D. Threaded, .040" 1.0mm
	GT045H	Contact Tip, H.D. Threaded, .045" 1.2mm
	GT364H	Contact Tip, H.D. Threaded, 3/64" 1.3mm
	GT052H	Contact Tip, H.D. Threaded, .052" 1.4mm
	GT116H	Contact Tip, H.D. Threaded, 1/16" 1.6mm
	GT564H	Contact Tip, H.D. Threaded, 5/64" 2.0mm
	GT332H	Contact Tip, H.D. Threaded, 3/32" 2.4mm
	GT764H	Contact Tip, H.D. Threaded, 7/64" 2.8mm
	GT018H	Contact Tip, H.D. Threaded, 1/8" 3.2mm
4.	GD114	Diffuser, 1/4" Recess, for GT Tips
	GD118	Diffuser, 1/8" Recess, for GT Tips
	GD100	Diffuser, Flush, for GT Tips
5.	B4635	Head Assy., for Long Contact Tip
	B4635-116	Head Assembly w/ Tube
6.	B4435	Head Assembly
	B4435-116	Head Assembly w/ Tube
7.	B4423R	Silicone Cap
8.	B4627	Body Tube Assembly
9.	B1518	Spacer Kit
9a.	B608	Handle Screw
10.	B4617	Insulator Spacer
11.	B408	Handle Kit
12.	B422	Trigger Switch Assembly
13.	B418	Trigger Switch Screw

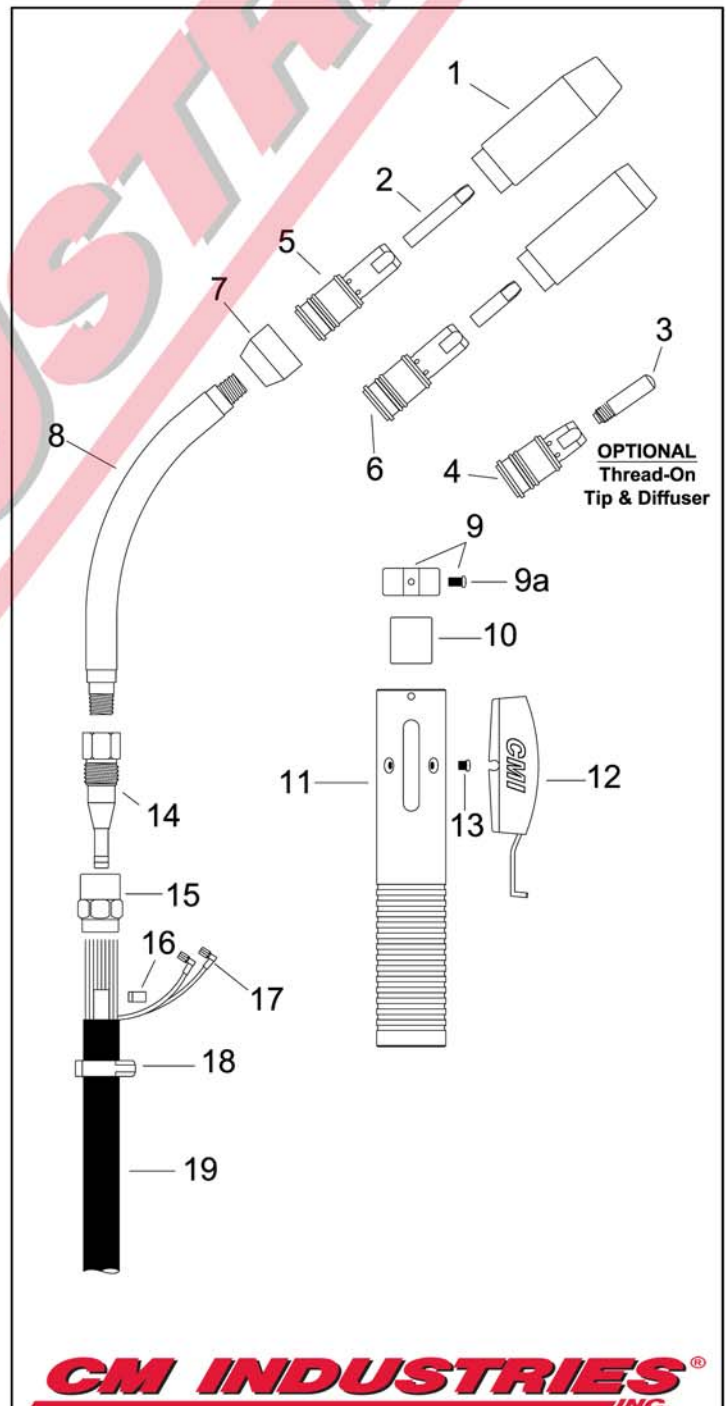

CM INDUSTRIES
INC.

#	Part Number	Description
14.	B4613	End Fitting
15.	B4616	Cone Nut
16.	B4992	Clamp, Conduit
17.	B457	Trigger Terminal
18.	B683	Clamp, Jacket
19.	B4641	600A Cable Assembly, 10'
	B4642	600A Cable Assembly, 12'
	B4645	600A Cable Assembly, 15'
	B4646	600A Cable Assembly, 20'
	B4647	600A Cable Assembly, 25'
20.	B2520041	Strain Relief Spring
21.	B2520066	Strain Relief Kit
22.	B2280065	Screw
23.	BGN2021	Electrical Plug, Miller
24.	B4719	Electrical Plug, Lincoln
25.	B1010027	Adaptor Block
26.	B2200101	Power Pin, Miller
27.	B4477	Power Pin Tip, Miller .023" - .045"
	B4477-564	Power Pin Tip, Miller .052" - 5/64"
	B4474	Power Pin Tip, Miller 3/32" - 1/8"
28.	B4478	O-Ring, Miller
29.	B2200118	Power Pin, Tweco 4
	B2200104	Power Pin, Tweco 5
30.	B4713	O-Ring, Tweco 4
31.	B2200099	Power Pin, Lincoln
32.	B4816	Euro Connector Nut
33.	B5060	Euro Connector Plug
34.	B4421	O-Ring, Euro
35.	B2520041	Strain Relief Spring
36.	B1880074	Rigid Strain Relief Kit
37.	B4207	Post Fastener
38.	B4209	Handle Screw
39.	B4925	Locking Sleeve
40.	B4901	Quick Connect Body
41.	B4924	Lead Wire
42.	B4919	Gas Pin Assembly
43.	B4916	Wave Spring
44.	B4912	Snap Ring, Small
45.	B4911	Snap Ring, Large
46.	B2200008	Power Pin, Bernard EZ
	B1199	Bernard Quick Disconnect Kit (39-46)
47.	B1986Q	600A Rear Cone Nut Repair Kit
48.	B44115	Liner Assembly, 15', .035"-.045"
	B44125	Liner Assembly, 25', .035"-.045"
	B44215	Liner Assembly, 15', .045"-.062"
	B44225	Liner Assembly, 25', .045"-.062"
	B44315	Liner Assembly, 15', 5/64"
	B44325	Liner Assembly, 25', 5/64"
	B45415	Liner Assembly, 15', 3/32"
	B45425	Liner Assembly, 25', 3/32"
	B45615	Liner Assembly, 15', 7/64"
	B45625	Liner Assembly, 25', 7/64"
	B44215X	Teflon Liner Assembly, 15', .045"-.062"

