

BND 400

AIR-COOLED MIG GUN

Replacement Suitable for Bernard®

RATING	GUN ORDERING PART NUMBER		GUN PLUG Direct Connect		
	PREVIOUS	CURRENT			
400 Amp CO2 @ 100% Duty Cycle	B2-44xxA	BQ40xxAE7CB	Bernard® Euro Hobart® Lincoln® "LN" Lincoln® "LF" Lincoln® W.M./Power MIG® Miller® Tweco® #4		
	B2-44xxAE	BQ40xxAE7CE			
	B2-44xxAH	BQ40xxAE7CH			
	B2-44xxAL	BQ40xxAE7CL			
	B2-44xxALF	BQ40xxAE7CS			
	B2-44xxAWM	BQ40xxAE7CU			
300 Amp Mixed Gas @ 100% Duty Cycle	B2-44xxAM	BQ40xxAE7CM			
	B2-44xxAT	BQ40xxAE7CT			
Wire Capacity: 0.035" (0.9mm) - 5/64" (2.0mm)					
	xx = Standard lengths of 10, 12, 15, 20 and 25 ft. Custom lengths also available.				

#	Part Number	Description	
1.	B4491	Nozzle - Brass 3/4" I.D.	
	B4591	Nozzle - Copper 3/4" I.D.	
	B4492	Nozzle - Brass 9/16" I.D.	
	B4592	Nozzle - Copper 9/16" I.D.	
	B4495	Nozzle - Brass 5/8" I.D.	
2.	B7489	Contact Tip, .035" 0.9mm	
	B7496	Contact Tip, .040" 1.0mm	
	B7490	Contact Tip, .045" 1.2mm	
	B7498	Contact Tip, .052" 1.4mm	
	B7491	Contact Tip, 1/16" 1.6mm	
	B1589	Contact Tip, Long, .035" 0.9mm	
	B1596	Contact Tip, Long, .040" 1.0mm	
	B1590	Contact Tip, Long, .045" 1.2mm	
	B1598	Contact Tip, Long, .052" 1.4mm	
	B1591	Contact Tip, Long, 1/16" 1.6mm	
B4285	B4285	Contact Tip, Tapered, .030" 0.8mm	
	B4281	Contact Tip, Tapered, .035" 0.9mm	
	B4299	Contact Tip, Tapered, .040" 1.0mm	
	B4282	Contact Tip, Tapered, .045" 1.2mm	
	B4283	Contact Tip, Tapered, .052" 1.4mm	
	B4280	Contact Tip, Tapered, 1/16" 1.6mm	
	2a.	CMI "Taper-LOCK" Contact Tips	
		155-1-030	H.D. Contact Tip, .030" (0.8mm)
155-1-035		H.D. Contact Tip, .035" (0.9mm)	
155-1-040		H.D. Contact Tip, .040" (1.0mm)	
155-1-045		H.D. Contact Tip, .045" (1.2mm)	
155-1-364		H.D. Contact Tip, 3/64" (1.2mm)	
155-1-052		H.D. Contact Tip, .052" (1.4mm)	
155-1-062		H.D. Contact Tip, .062" (1.6mm)	
155-1-564		H.D. Contact Tip, 5/64" (2.0mm)	
155-1-332		H.D. Contact Tip, 3/32" (2.4mm)	
155-2-030		H.D. Tapered Contact Tip, .030" (0.8mm)	
155-2-035		H.D. Tapered Contact Tip, .035" (0.9mm)	
155-2-040		H.D. Tapered Contact Tip, .040" (1.0mm)	
155-2-045		H.D. Tapered Contact Tip, .045" (1.2mm)	
155-2-364	H.D. Tapered Contact Tip, 3/64" (1.2mm)		
155-2-052	H.D. Tapered Contact Tip, .052" (1.4mm)		
155-2-062	H.D. Tapered Contact Tip, .062" (1.6mm)		
2b.	B4435-TL18	Head Assembly, for Taper-LOCK™ Tip	
3.	B4435	Head Assembly	
	B4435-116	Head Assembly w/ Tube	
4.	B4635	Head Assy., for Long Contact Tip	
	B4635-116	Head Assembly w/ Tube	
5.	B4423R	Silicone Cap	
6.	BQT3-30	Body Tube, Medium 30°	
	BQT3-45	Body Tube, Medium 45°	
	BQT3-60	Body Tube, Medium 60°	
	BQT3-80	Body Tube, Medium 80°	

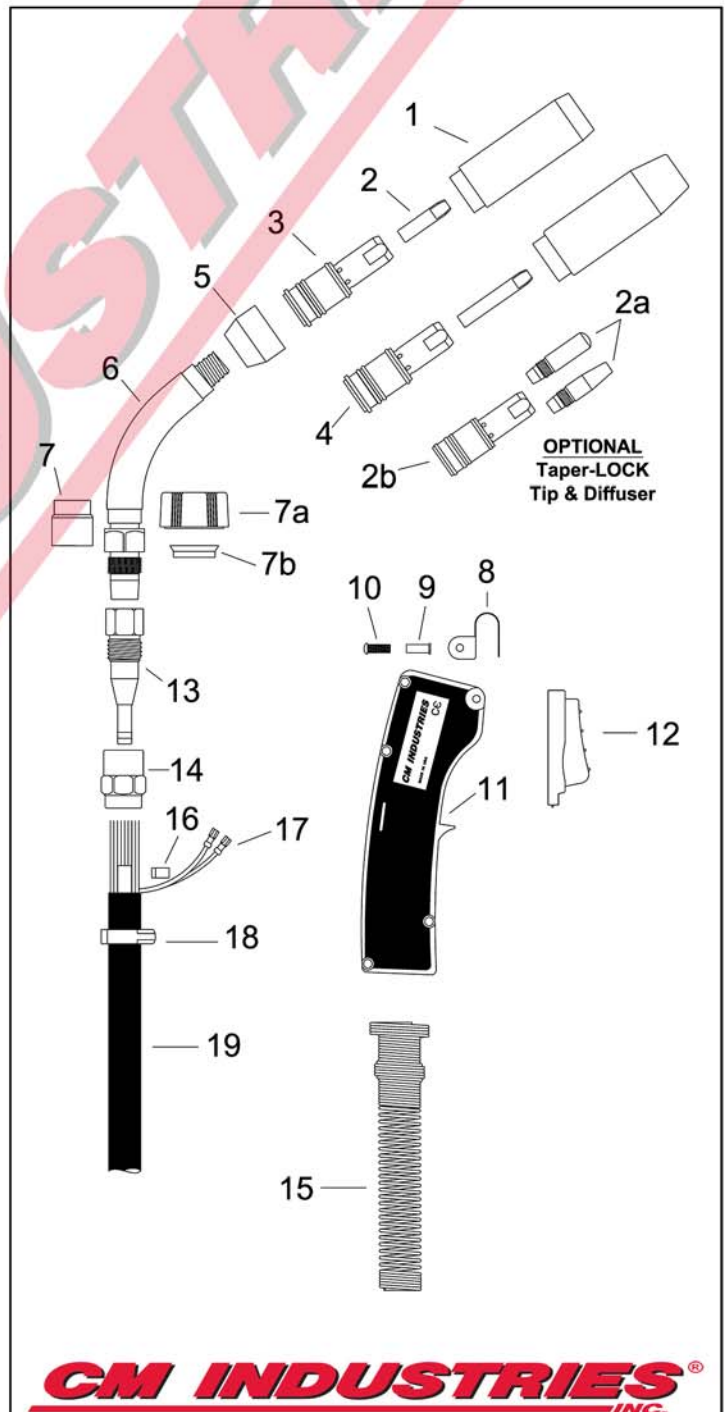

CM INDUSTRIES INC.

COPYRIGHT © 2014 CM INDUSTRIES, INC. ALL RIGHTS RESERVED

#	Part Number	Description
7.	B4780	Insulator Hex Nut
7a.	B1840057	Plastic Lock Nut
7b.	B1840031	Silicone Rubber Seal
8.	B4238	Hang Up Hook
9.	B4207	Post Fastener
10.	B4209	Handle Screw
	B1880004	Screw/Post Kit
11.	B1880198	Handle Kit w/ Screws
12.	B5662	Trigger Assembly
13.	B4313B	End Fitting
14.	B1540003	Cone Nut
15.	B2520042	Handle Spring
16.	B4992	Clamp, Conduit
17.	B2660001	Trigger Terminal
18.	B683	Clamp, Jacket
19.	B1060115	400A Cable Assembly, 10'
	B1060116	400A Cable Assembly, 12'
	B1060117	400A Cable Assembly, 15'
	B1060118	400A Cable Assembly, 20'
	B1060119	400A Cable Assembly, 25'
20.	B2520041-S	Strain Relief Spring
21.	B2520066	Strain Relief Kit
22.	B2280056	Screw
23.	BGN2021	Electrical Plug, Miller
24.	B4719	Electrical Plug, Lincoln
25.	B1010027	Adaptor Block
26.	B2200101	Power Pin, Miller
27.	B4477	Power Pin Tip, Miller .023" - .045"
	B4477-564	Power Pin Tip, Miller .052" - 5/64"
28.	B4478	O-Ring, Miller
29.	B2200118	Power Pin, Tweco 4
30.	B4713	O-Ring, Tweco 4
31.	B2200099	Power Pin, Lincoln "LN"
32.	B4816	Euro Connector Nut
33.	B5060	Euro Connector Plug
34.	B4421	O-Ring, Euro
35.	B2520041-S	Strain Relief Spring
36.	B1880074	Rigid Strain Relief Kit
37.	B4925	Locking Sleeve
38.	B4901	Quick Connect Body
39.	B4924	Lead Wire
40.	B4919	Gas Pin Assembly
41.	B4916	Wave Spring
42.	B4912	Snap Ring, Small
43.	B4911	Snap Ring, Large
44.	B2200008	Power Pin, Bernard EZ
	B1199	Bernard Quick Disconnect Kit (37-44)
45.	B1984Q	400A Rear Cone Nut Repair Kit
46.	B44115	Liner Assembly, 15', .035"-.045"
	B44125	Liner Assembly, 25', .035"-.045"
	B44215	Liner Assembly, 15', .045"-.062"
	B44225	Liner Assembly, 25', .045"-.062"
	B44315	Liner Assembly, 15', 5/64"
	B44325	Liner Assembly, 25', 5/64"
	B43115X	Teflon Liner Assembly, 15', .035"- 3/64"
	B44215X	Teflon Liner Assembly, 15', .045"-.062"

