

# CM INDUSTRIES TRG 450W Euro

## WATER-COOLED MIG TORCH

Item	450 AMP	Description
1.	152-30-50C 152-30-62C 152-30-75C 152-31-50C 152-31-62C 152-31-75C 152-32-50C 152-32-62C	Nozzle, Copper H.D., 1/2", 1/8" Tip Recess Nozzle, Copper H.D., 5/8", 1/8" Tip Recess, Std. Nozzle, Copper H.D., 3/4", 1/8" Tip Recess Nozzle, Copper H.D., 1/2", 1/4" Tip Recess Nozzle, Copper H.D., 5/8", 1/4" Tip Recess Nozzle, Copper H.D., 3/4", 1/4" Tip Recess Nozzle, Copper H.D., 1/2", Flush Tip Nozzle, Copper H.D., 5/8", Flush Tip
2.	<b>CMI Taper-LOCK™ Contact Tips</b> 155-1-030 155-1-035 155-1-040 155-1-045 155-1-364 155-1-052 155-1-062 155-1-564 155-1-332  155-2-030 155-2-035 155-2-040 155-2-045 155-2-364 155-2-052 155-2-062	H.D. Contact Tip, .030" (0.8mm) H.D. Contact Tip, .035" (0.9mm) H.D. Contact Tip, .040" (1.0mm) H.D. Contact Tip, .045" (1.2mm) H.D. Contact Tip, 3/64" (1.2mm) H.D. Contact Tip, .052" (1.4mm) H.D. Contact Tip, .062" (1.6mm) H.D. Contact Tip, 5/64" (2.0mm) H.D. Contact Tip, 3/32" (2.4mm)  H.D. Tapered Contact Tip, .030" (0.8mm) H.D. Tapered Contact Tip, .035" (0.9mm) H.D. Tapered Contact Tip, .040" (1.0mm) H.D. Tapered Contact Tip, .045" (1.2mm) H.D. Tapered Contact Tip, 3/64" (1.2mm) H.D. Tapered Contact Tip, .052" (1.4mm) H.D. Tapered Contact Tip, .062" (1.6mm)
3.	154-R505	Diffuser H.D., for Taper-LOCK™ Tip
3a.	154-1	Replacement Retaining Ring
3b.	154-2	Replacement O-Ring
4.	154-R506	Diffuser, for Taper-LOCK™ Tip
4a.	154-1	Replacement Retaining Ring
4b.	154-2	Replacement O-Ring
5.	R455-45 R455-60 5a. R452-3	Gooseneck, 45° Gooseneck, 60° Gooseneck Insulator
6.	R411-1	Switch Only
7.	R411-2	Switch Housing
8.	R411-3	Mounting Screw
9.	R610	Handle w/ Spring
10.	R659-10 R659-12 R659-15	Power Cable, 10' Power Cable, 12' Power Cable, 15'
11.	R656-10 R656-12 R656-15	Water Hose, 10' Water Hose, 12' Water Hose, 15'
12.	R656-1	Hose Clamp
13.	R657	Conduit (sold per ft.)
14.	R657-1	Conduit Clamp
15.	216-52-000	Outer Cable Cover 26mm (sold per ft.)
16.	185-52-001	Cable Support Spring
17.	260-52-202	Adaptor Support
19.	R658	Red Water Line OUT, 2'
20.	350-52-001	Male Water Fitting
21.	401-00-001	Adaptor Nut
22.	R675-10	Quick Connector Power Block Assembly
23.	R415-35-15 R415-116-15 R415-564-15 R415-332-15 R415-35-2 R415-116-2	Liner Assembly .035", 15' Liner Assembly 1/16", 15' Liner Assembly 5/64", 15' Liner Assembly 3/32", 15' Liner Assembly .035", Aluminum 15' Liner Assembly 1/16", Aluminum 15'

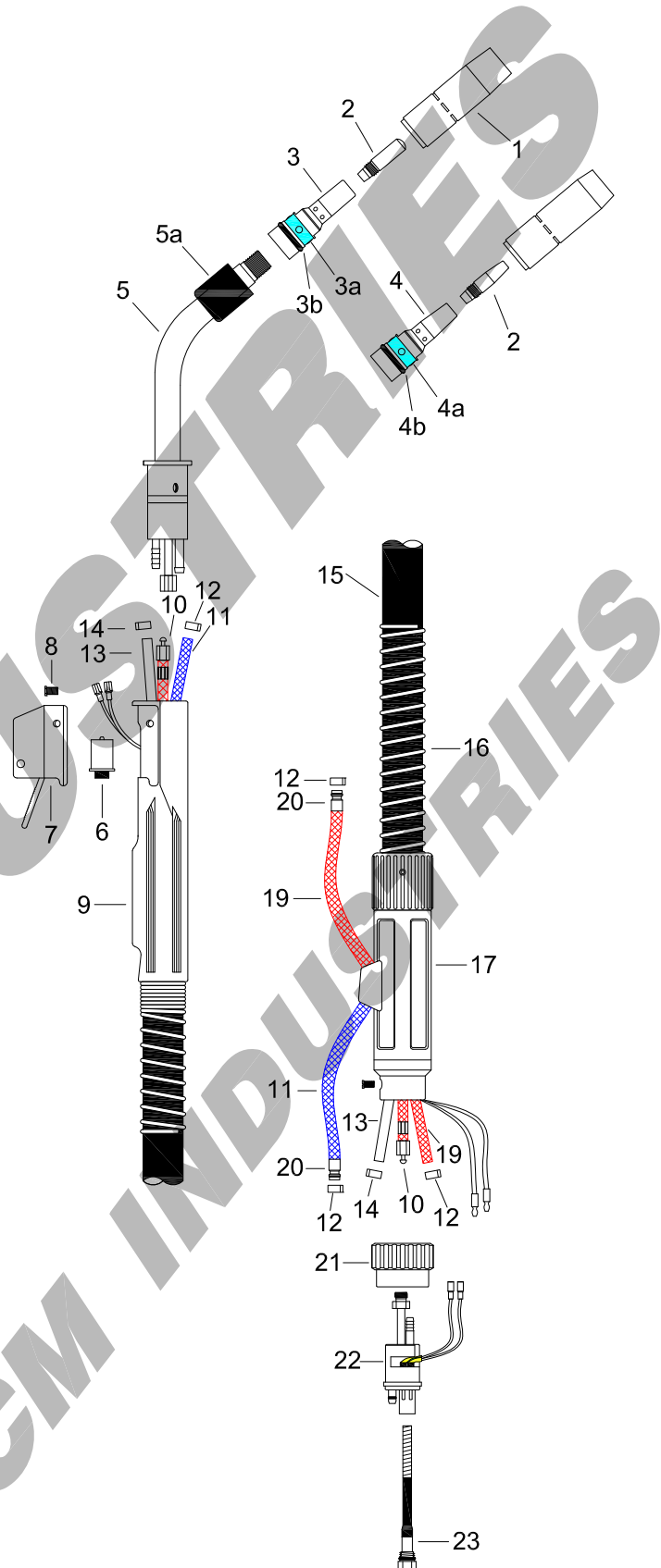

Manufactured in Lake Zurich, Illinois by CM Industries, Inc.

# WARNING!

## Please read all Safety Instructions



# WARNING

- Read and follow the manufacturer's instructions, employer's safety practices, and Material Safety Data Sheets (MSDSs).
- Only qualified personnel should install, use, or service this material and/or equipment.



### **ELECTRIC SHOCK can kill.**

- Always wear dry insulating gloves.
- Do not touch live electrical parts.
- Always disconnect power source before hooking up or changing electrodes, nozzles and other parts.



### **WELDING SPARKS can cause fire or explosion**

- Do not weld near flammable material.
- Do not weld on closed containers.
- Remove combustibles from the work area and/or provide a fire watch.
- Avoid oily or greasy clothing as a spark may ignite them.



### **LOUD NOISE can damage hearing.**

- Always wear protective hearing devices to ensure protection when noise levels exceed OSHA standards.



### **ARC RAYS can injure eyes and burn skin.**

- Always wear correct eye, ear, and body protection.
- Always wear a welding helmet with the proper grade filter lens. Protect yourself and others from spatter arc rays by using protective screens, barriers and welding curtains.
- Always wear protective gloves and clothing to cover exposed skin. This will aid in the prevention of arc and spatter burns.



### **FUMES AND GASES can be hazardous to your health.**

- Keep your head out of the fumes.
- Use enough ventilation or exhaust at the arc to keep fumes and gases from your breathing zone, and general area.
- Fumes from cutting and welding can deplete air quality, causing injury or death. Always wear an air supplied respirator in confined areas, or if breathing air is not safe.

Read American National Standard Z49.1, "Safety in Welding, Cutting, and Allied Processes," available from American Welding Society, 550 N.W. LeJeune Rd., Miami, FL 33126;

OSHA Safety and health standards, available from U.S. Government Printing Office, Washington DC 20402

## **CM INDUSTRIES<sup>®</sup>**

**INC.**

505 OAKWOOD RD. LAKE ZURICH, IL 60047 USA

PHONE: 847-550-0033 FAX: 847-550-0444

[www.cmindustries.com](http://www.cmindustries.com)