

# TWC 180

# AIR-COOLED MIG GUN

Replacement Suitable for Tweco®

RATING	GUN ORDERING PART NUMBER	GUN PLUG Direct Connect
<b>180 Amp CO2 @ 80% Duty Cycle</b>  <b>120 Amp Mixed Gas @ 80% Duty Cycle</b>  <b>Wire Capacity: 0.023" (0.6mm) - 0.045" (1.2mm)</b>	C1xx-3035 CC1xx-3035 CX1xx-3035 CH1xx-3035 CL1xx-3035 CLPM1xx-3035 CM1xx-3035 CP1xx-3035	Tweco® #4 Century® Euro Hobart® Lincoln® "LN" Lincoln® W.M./Power MIG® Miller® Panasonic®
	xx = Standard lengths of 10, 12, 15, 20 and 25 ft. Custom lengths also available.	

#	Part Number	Description
1.	C21-50	Nozzle, 1/2" I.D., Std.
	C21-50-F	Nozzle, 1/2" I.D. Flush
	C21-62	Nozzle, 5/8" I.D.
	C21-62-F	Nozzle, 5/8" I.D. Flush
	C21-62-FAS	Nozzle, Spot Nozzle
	C21-37	Nozzle, 3/8" I.D.
	C21-37-F	Nozzle, 3/8" I.D. Flush
	C21T-37	Nozzle, Tapered 3/8" I.D.
	C21T-37-F	Nozzle, Tapered 3/8" I.D. Flush
	2.	C11-23
C11-30		Contact Tip, .030" 0.8mm
C11-35		Contact Tip, .035" 0.9mm, Std.
C11-40		Contact Tip, .040" 1.0mm
C11-45		Contact Tip, .045" 1.2mm
C11H-35		Contact Tip, H.D., .035" 0.9mm
C11H-45		Contact Tip, H.D., .045" 1.2mm
C11AH-364		Contact Tip, H.D., Aluminum, 3/64"
C11T-23		Contact Tip, Tapered, .023" 0.6mm
C11T-30		Contact Tip, Tapered, .030" 0.8mm
C11T-35	Contact Tip, Tapered, .035" 0.9mm	
C11T-40	Contact Tip, Tapered, .040" 1.0mm	
C11T-45	Contact Tip, Tapered, .045" 1.2mm	
3.	C51	Gas Diffuser, Std.
	C51-23	Gas Diffuser, For .023" Wire
4.	C61-45	Conductor Tube, 45°
	C61-60	Conductor Tube, 60°, Std.
	C61-180	Conductor Tube, 180° (Includes Items 4 & 5)
5.	C71	Conductor Tube Insulation
6.	C61R	Conductor Tube Nut
7.	C81	Handle w/ Screws, TWC 180
8.	C91	Trigger Switch w/ Blades
9.	C122FM	Binder Post & Screw
10.	C101CM	Cable Connector
11.	C44C	Replacement Set Screw
12.	C244DS	Control Wire Terminal
13.	C141-6S	Power Cable Support Spring
14.	C180-10	Power Cable, 10'
	C180-12	Power Cable, 12'
	C180-15	Power Cable, 15'
	C180-20	Power Cable, 20'
	C180-25	Power Cable, 25'

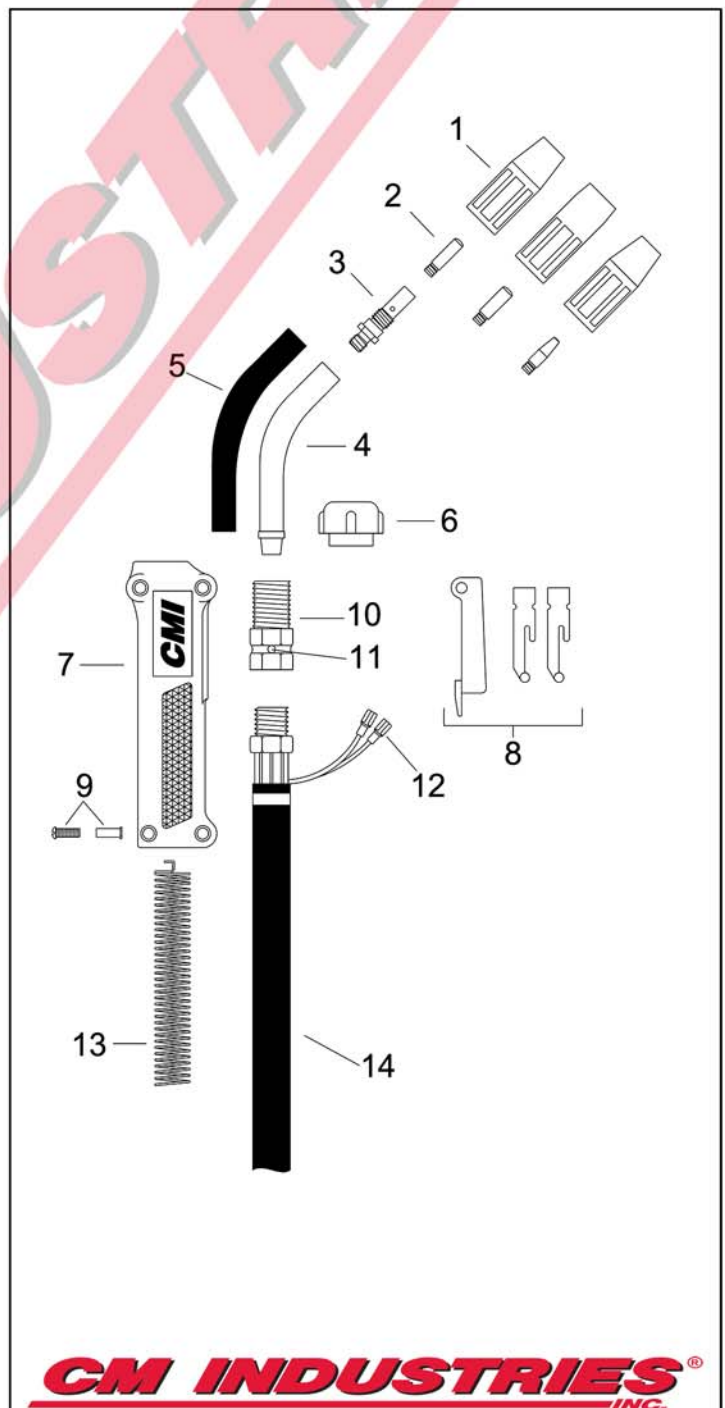

**CM INDUSTRIES**  
INC.

#	Part Number	Description
15.	C350R-230-10S	Cable Support Spring
16.	CR6RC	Round Connector Case
17.	C350-174H	Gun Plug, Tweco
18.	C224	O-Ring
19.	C44C	Set Screw
20.	C350-174MH	Gun Plug, Miller
21.	C174M-N	Conduit Nut, Miller
22.	C350-174LH	Gun Plug, Lincoln
23.	300-05-001	Electrical Plug, Miller & Lincoln Power MIG
24.	300-05-002	Electrical Plug, Lincoln LN & LF
25.	C180-10E C180-12E C180-15E C180-20E C180-25E	Euro Power Cable, 10' Euro Power Cable, 12' Euro Power Cable, 15' Euro Power Cable, 20' Euro Power Cable, 25'
26.	185-26-001	Cable Support Spring
27.	260-25-002	Adaptor Support, Euro
28.	285-01-001	Adaptor Support Screw
29.	290-01-012	Hex Nut, M12
30.	300-05-010	Male Terminal
31.	C174X-2	Adaptor Nut
32.	C174EX-1	Euro-Kwik Adaptor Assembly
33.	C174EX-1G	O-Ring, Euro
34.	C174EX-1C	Conduit Nut, Euro-Kwik
35.	C42-23-15 C42-3035-15 C42-3035-25 C42-4045-15 C42-4045-25 C42N-3545-15	Liner Assembly, 15' .023" Liner Assembly, 15' .030"-.035", Std. Liner Assembly, 25' .030"-.035" Liner Assembly, 15' .040"-.045" Liner Assembly, 25' .040"-.045" Nylon Liner Assembly, 15' .035"-.045"

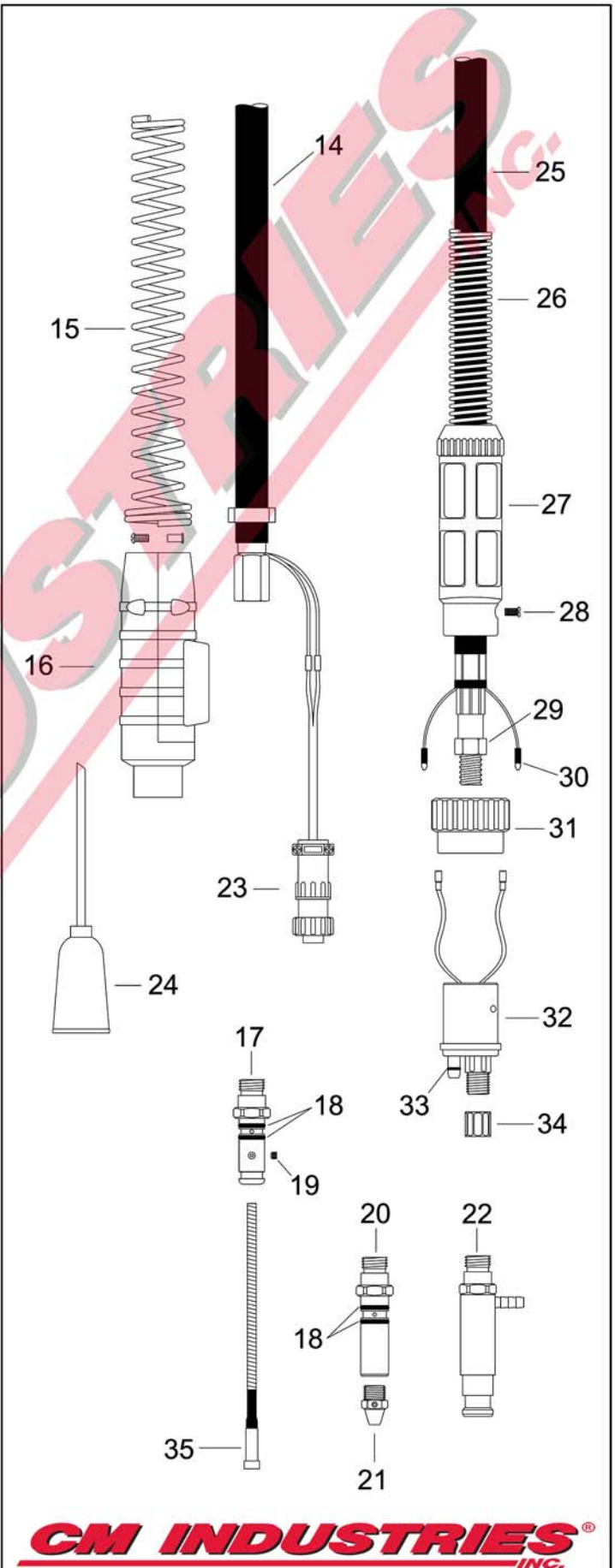

# WARNING!

## Please read all Safety Instructions



# WARNING

- Read and follow the manufacturer's instructions, employer's safety practices, and Material Safety Data Sheets (MSDSs).
- Only qualified personnel should install, use, or service this material and/or equipment.



### **ELECTRIC SHOCK can kill.**

- Always wear dry insulating gloves.
- Do not touch live electrical parts.
- Always disconnect power source before hooking up or changing electrodes, nozzles and other parts.



### **WELDING SPARKS can cause fire or explosion**

- Do not weld near flammable material.
- Do not weld on closed containers.
- Remove combustibles from the work area and/or provide a fire watch.
- Avoid oily or greasy clothing as a spark may ignite them.



### **LOUD NOISE can damage hearing.**

- Always wear protective hearing devices to ensure protection when noise levels exceed OSHA standards.



### **ARC RAYS can injure eyes and burn skin.**

- Always wear correct eye, ear, and body protection.
- Always wear a welding helmet with the proper grade filter lens. Protect yourself and others from spatter arc rays by using protective screens, barriers and welding curtains.
- Always wear protective gloves and clothing to cover exposed skin. This will aid in the prevention of arc and spatter burns.



### **FUMES AND GASES can be hazardous to your health.**

- Keep your head out of the fumes.
- Use enough ventilation or exhaust at the arc to keep fumes and gases from your breathing zone, and general area.
- Fumes from cutting and welding can deplete air quality, causing injury or death. Always wear an air supplied respirator in confined areas, or if breathing air is not safe.

Read American National Standard Z49.1, "Safety in Welding, Cutting, and Allied Processes," available from American Welding Society, 550 N.W. LeJeune Rd., Miami, FL 33126;  
 OSHA Safety and health standards, available from U.S. Government Printing Office, Washington DC 20402

**CM INDUSTRIES<sup>®</sup>**  
**INC.**

505 OAKWOOD RD. LAKE ZURICH, IL 60047 USA  
 PHONE: 847-550-0033 FAX: 847-550-0444  
[www.cmindustries.com](http://www.cmindustries.com)