

BND 300

AIR-COOLED MIG GUN

Replacement Suitable for Bernard®

RATING	GUN ORDERING PART NUMBER		GUN PLUG Direct Connect
	PREVIOUS	CURRENT	
300 Amp CO2 @ 100% Duty Cycle 250 Amp Mixed Gas @ 100% Duty Cycle Wire Capacity: 0.030" (0.8mm) - 0.062" (1.6mm)	B2-43xxA	BQ30xxAE7CB	Bernard® Euro Hobart® Lincoln® "LN" Lincoln® "LF" Lincoln® W.M./Power MIG® Miller® Tweco® #4
	B2-43xxAE	BQ30xxAE7CE	
	B2-43xxAH	BQ30xxAE7CH	
	B2-43xxAL	BQ30xxAE7CL	
	B2-43xxALF	BQ30xxAE7CS	
	B2-43xxAWM	BQ30xxAE7CU	
	B2-43xxAM	BQ30xxAE7CM	
B2-43xxAT	BQ30xxAE7CT		
xx = Standard lengths of 10, 12, 15, 20 and 25 ft. Custom lengths also available.			

#	Part Number	Description
1.	B4391	Nozzle - Brass 5/8" I.D.
	B4393	Nozzle - Copper 5/8" I.D.
	B4392	Nozzle - Brass 1/2" I.D.
	B4394	Nozzle - Copper 1/2" I.D.
	B4295	Nozzle - Brass Tapered, Long - 11/32" I.D.
2.	B7497	Contact Tip, .023" (0.6mm)
	B7488	Contact Tip, .030" (0.8mm)
	B7489	Contact Tip, .035" (0.9mm)
	B7496	Contact Tip, .040" (1.0mm)
	B7490	Contact Tip, .045" (1.2mm)
	B7498	Contact Tip, .052" (1.4mm)
	B7491	Contact Tip, 1/16" (1.6mm)
	B1597	Contact Tip, Long, .023" (0.6mm)
	B1588	Contact Tip, Long, .030" (0.8mm)
	B1589	Contact Tip, Long, .035" (0.9mm)
	B1596	Contact Tip, Long, .040" (1.0mm)
	B1590	Contact Tip, Long, .045" (1.2mm)
	B1598	Contact Tip, Long, .052" (1.4mm)
	B1591	Contact Tip, Long, 1/16" (1.6mm)
	B4285	Contact Tip, Tapered, .035" (0.8mm)
B4281	Contact Tip, Tapered, .035" (0.9mm)	
B4299	Contact Tip, Tapered, .040" (1.0mm)	
B4282	Contact Tip, Tapered, .045" (1.2mm)	
B4283	Contact Tip, Tapered, .052" (1.4mm)	
B4280	Contact Tip, Tapered, 1/16" (1.6mm)	
2a.	CMI "Taper-LOCK" Contact Tips	
	155-1-030	H.D. Contact Tip, .030" (0.8mm)
	155-1-035	H.D. Contact Tip, .035" (0.9mm)
	155-1-040	H.D. Contact Tip, .040" (1.0mm)
	155-1-045	H.D. Contact Tip, .045" (1.2mm)
	155-1-364	H.D. Contact Tip, 3/64" (1.2mm)
	155-1-052	H.D. Contact Tip, .052" (1.4mm)
	155-1-062	H.D. Contact Tip, .062" (1.6mm)
	155-1-564	H.D. Contact Tip, 5/64" (2.0mm)
	155-1-332	H.D. Contact Tip, 3/32" (2.4mm)
	155-2-030	H.D. Tapered Contact Tip, .030" (0.8mm)
	155-2-035	H.D. Tapered Contact Tip, .035" (0.9mm)
	155-2-040	H.D. Tapered Contact Tip, .040" (1.0mm)
	155-2-045	H.D. Tapered Contact Tip, .045" (1.2mm)
	155-2-364	H.D. Tapered Contact Tip, 3/64" (1.2mm)
155-2-052	H.D. Tapered Contact Tip, .052" (1.4mm)	
155-2-062	H.D. Tapered Contact Tip, .062" (1.6mm)	
2b.	B4335-TL18	Head Assembly, for Taper-LOCK™ Tip
3.	B4335	Head Assembly, Std.
	B4335-116	Head Assembly w/ Tube
4.	B4235	Head Assy., for Long Contact Tip
	B4235-116	Head Assembly w/ Tube
5.	B4323R	Silicone Cap

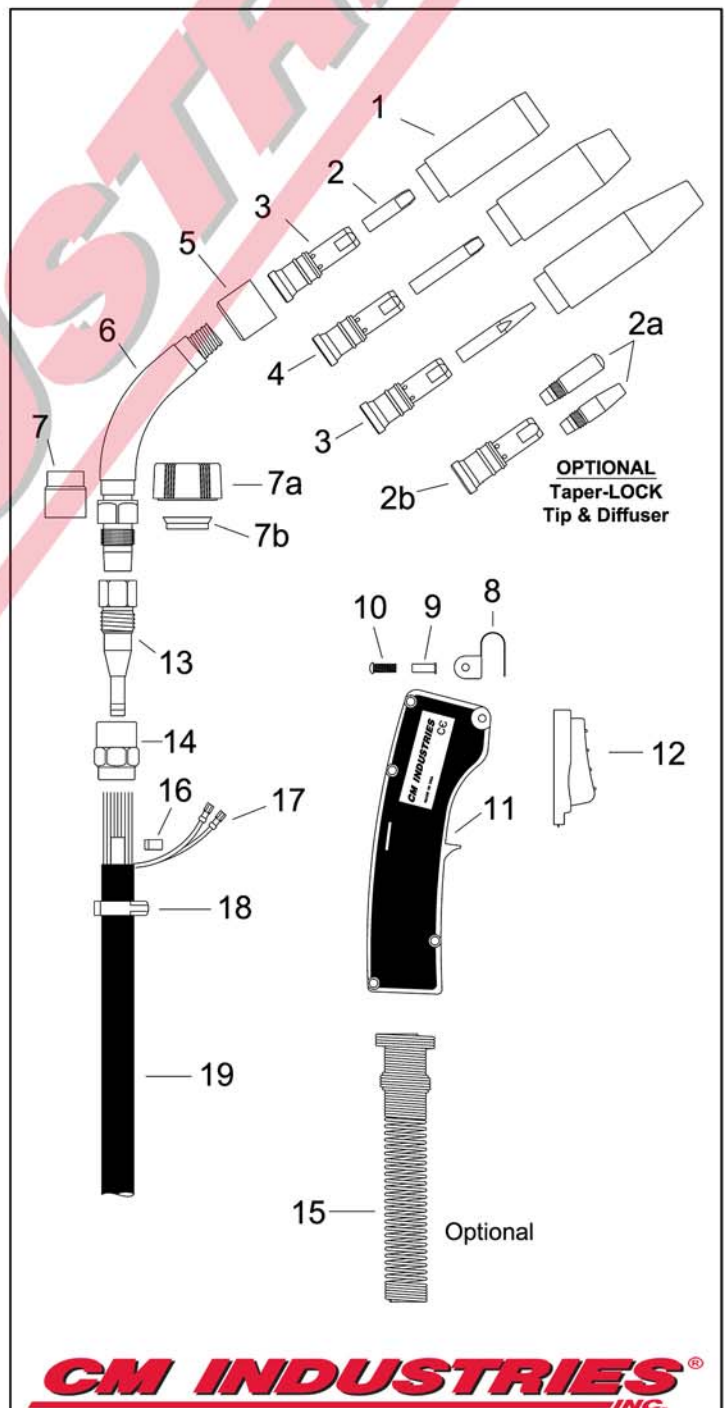

CM INDUSTRIES INC.

COPYRIGHT © 2014 CM INDUSTRIES, INC. ALL RIGHTS RESERVED

#	Part Number	Description
6.	BQT3-30 BQT3-45 BQT3-60 BQT3-80	Body Tube, Medium 30° Body Tube, Medium 45°, Std. Body Tube, Medium 60° Body Tube, Medium 80°
7.	B4780	Insulator Hex Nut
7a.	B1840057	Plastic Lock Nut
7b.	B1840031	Silicone Rubber Seal
8.	B4238	Hang Up Hook
9.	B4207	Post Fastener
10.	B4209 B1880004	Handle Screw Screw/Post Kit
11.	B1880155	Handle Kit w/ Screws
12.	B5662	Trigger Assembly
13.	B4313B	End Fitting
14.	B4305	Cone Nut
15.	B2520074	Handle Spring - Optional
16.	B4991	Clamp, Conduit
17.	B2660001	Trigger Terminal
18.	B4823	Clamp, Jacket
19.	B1060109 B1060110 B1060111 B1060112 B1060113	300A Cable Assembly, 10' 300A Cable Assembly, 12' 300A Cable Assembly, 15' 300A Cable Assembly, 20' 300A Cable Assembly, 25'
20.	B2520041-S	Strain Relief Spring
21.	B2520066	Strain Relief Kit
22.	B2280056	Screw
23.	BGN2021	Electrical Plug, Miller
24.	B4719	Electrical Plug, Lincoln
25.	B1010027	Adaptor Block
26.	B2200101	Power Pin, Miller
27.	B4477 B4477-564	Power Pin Tip, Miller .023" - .045" Power Pin Tip, Miller .052" - 5/64"
28.	B4478	O-Ring, Miller
29.	B2200118	Power Pin, Tweco 4
30.	B4713	O-Ring, Tweco
31.	B2200099	Power Pin, Lincoln "LN"
32.	B4816	Euro Connector Nut
33.	B5060	Euro Connector Plug
34.	B4421	O-Ring, Euro
35.	B2520041-S	Strain Relief Spring
36.	B1880074	Rigid Strain Relief Kit
37.	B4925	Locking Sleeve
38.	B4901	Quick Connect Body
39.	B4924	Lead Wire
40.	B4919	Gas Pin Assembly
41.	B4916	Wave Spring
42.	B4912	Snap Ring, Small
43.	B4911	Snap Ring, Large
44.	B2200008	Power Pin, Bernard EZ
	B1199	Bernard Quick Disconnect Kit (37-44)
45.	B1983Q	300A Rear Cone Nut Repair Kit
46.	B43015 B43115 B43125 B43215 B43225	Liner Assembly, 15', .023"-.030" Liner Assembly, 15', .035"-.045" Liner Assembly, 25', .035"-.045" Liner Assembly, 15', .045"-.062" Liner Assembly, 25', .045"-.062"
	B43115X	Teflon Liner Assembly, 15', .035"- 3/64"

