

# BND 350

# AIR-COOLED MIG GUN

Replacement Suitable for Bernard®

| RATING  | GUN ORDERING PART NUMBER  |             | GUN PLUG<br>Direct Connect  |  |
|---|---|-------------|---|--|
|   | PREVIOUS  | CURRENT     |   |  |
| <b>350 Amp CO2<br/>@ 100% Duty Cycle</b><br><br><b>250 Amp Mixed Gas<br/>@ 100% Duty Cycle</b><br><br><b>Wire Capacity:<br/>0.030" (0.8mm) -<br/>0.062" (1.6mm)</b> | B2-435xxA   | BQ35xxAE7CB | <b>Bernard®</b><br><b>Euro</b><br><b>Hobart®</b><br><b>Lincoln® "LN"</b><br><b>Lincoln® "LF"</b><br><b>Lincoln® W.M./Power MIG®</b><br><b>Miller®</b><br><b>Tweco® #4</b> |  |
|   | B2-435xxAE  | BQ35xxAE7CE |   |  |
|   | B2-435xxAH  | BQ35xxAE7CH |   |  |
|   | B2-435xxAL  | BQ35xxAE7CL |   |  |
|   | B2-435xxALF   | BQ35xxAE7CS |   |  |
|   | B2-435xxAWM   | BQ35xxAE7CU |   |  |
|   | B2-435xxAM  | BQ35xxAE7CM |   |  |
|   | B2-435xxAT  | BQ35xxAE7CT |   |  |
|   | xx = Standard lengths of 10, 12, 15, 20 and 25 ft. Custom lengths also available. |             |   |  |

| #     | Part Number                          | Description                             |                                    |
|-------|--------------------------------------|---|------------------------------------|
| 1.    | B4491                                | Nozzle - Brass 3/4" I.D.                |                                    |
|       | B4591                                | Nozzle - Copper 3/4" I.D.               |                                    |
|       | B4492                                | Nozzle - Brass 9/16" I.D.               |                                    |
|       | B4592                                | Nozzle - Copper 9/16" I.D.              |                                    |
|       | B4495                                | Nozzle - Brass 5/8" I.D.                |                                    |
| 2.    | B7489                                | Contact Tip, .035" 0.9mm                |                                    |
|       | B7496                                | Contact Tip, .040" 1.0mm                |                                    |
|       | B7490                                | Contact Tip, .045" 1.2mm                |                                    |
|       | B7498                                | Contact Tip, .052" 1.4mm                |                                    |
|       | B7491                                | Contact Tip, 1/16" 1.6mm                |                                    |
|       | B1589                                | Contact Tip, Long, .035" 0.9mm          |                                    |
|       | B1596                                | Contact Tip, Long, .040" 1.0mm          |                                    |
|       | B1590                                | Contact Tip, Long, .045" 1.2mm          |                                    |
|       | B1598                                | Contact Tip, Long, .052" 1.4mm          |                                    |
|       | B1591                                | Contact Tip, Long, 1/16" 1.6mm          |                                    |
|       | B4285                                | Contact Tip, Tapered, .030" 0.8mm       |                                    |
|       | B4281                                | Contact Tip, Tapered, .035" 0.9mm       |                                    |
|       | B4299                                | Contact Tip, Tapered, .040" 1.0mm       |                                    |
|       | B4282                                | Contact Tip, Tapered, .045" 1.2mm       |                                    |
|       | B4283                                | Contact Tip, Tapered, .052" 1.4mm       |                                    |
| B4280 | Contact Tip, Tapered, 1/16" 1.6mm    |   |                                    |
| 2a.   | <b>CMI "Taper-LOCK" Contact Tips</b> |   |                                    |
|       | 155-1-030                            | H.D. Contact Tip, .030" (0.8mm)         |                                    |
|       | 155-1-035                            | H.D. Contact Tip, .035" (0.9mm)         |                                    |
|       | 155-1-040                            | H.D. Contact Tip, .040" (1.0mm)         |                                    |
|       | 155-1-045                            | H.D. Contact Tip, .045" (1.2mm)         |                                    |
|       | 155-1-364                            | H.D. Contact Tip, 3/64" (1.2mm)         |                                    |
|       | 155-1-052                            | H.D. Contact Tip, .052" (1.4mm)         |                                    |
|       | 155-1-062                            | H.D. Contact Tip, .062" (1.6mm)         |                                    |
|       | 155-1-564                            | H.D. Contact Tip, 5/64" (2.0mm)         |                                    |
|       | 155-1-332                            | H.D. Contact Tip, 3/32" (2.4mm)         |                                    |
|       | 155-2-030                            | H.D. Tapered Contact Tip, .030" (0.8mm) |                                    |
|       | 155-2-035                            | H.D. Tapered Contact Tip, .035" (0.9mm) |                                    |
|       | 155-2-040                            | H.D. Tapered Contact Tip, .040" (1.0mm) |                                    |
|       | 155-2-045                            | H.D. Tapered Contact Tip, .045" (1.2mm) |                                    |
|       | 155-2-364                            | H.D. Tapered Contact Tip, 3/64" (1.2mm) |                                    |
|       | 155-2-052                            | H.D. Tapered Contact Tip, .052" (1.4mm) |                                    |
|       | 155-2-062                            | H.D. Tapered Contact Tip, .062" (1.6mm) |                                    |
|       | 2b.                                  | B4435-TL18                              | Head Assembly, for Taper-LOCK™ Tip |
|       | 3.                                   | B4435                                   | Head Assembly                      |
|       |                                      | B4435-116                               | Head Assembly w/ Tube              |
| B4635 |                                      | Head Assy., for Long Contact Tip        |                                    |
| 4.    | B4635                                | Head Assy., for Long Contact Tip        |                                    |
|       | B4635-116                            | Head Assembly w/ Tube                   |                                    |
| 5.    | B4423R                               | Silicone Cap                            |                                    |
| 6.    | BQT3-30                              | Body Tube, Medium 30°                   |                                    |
|       | BQT3-45                              | Body Tube, Medium 45°                   |                                    |
|       | BQT3-60                              | Body Tube, Medium 60°                   |                                    |
|       | BQT3-80                              | Body Tube, Medium 80°                   |                                    |

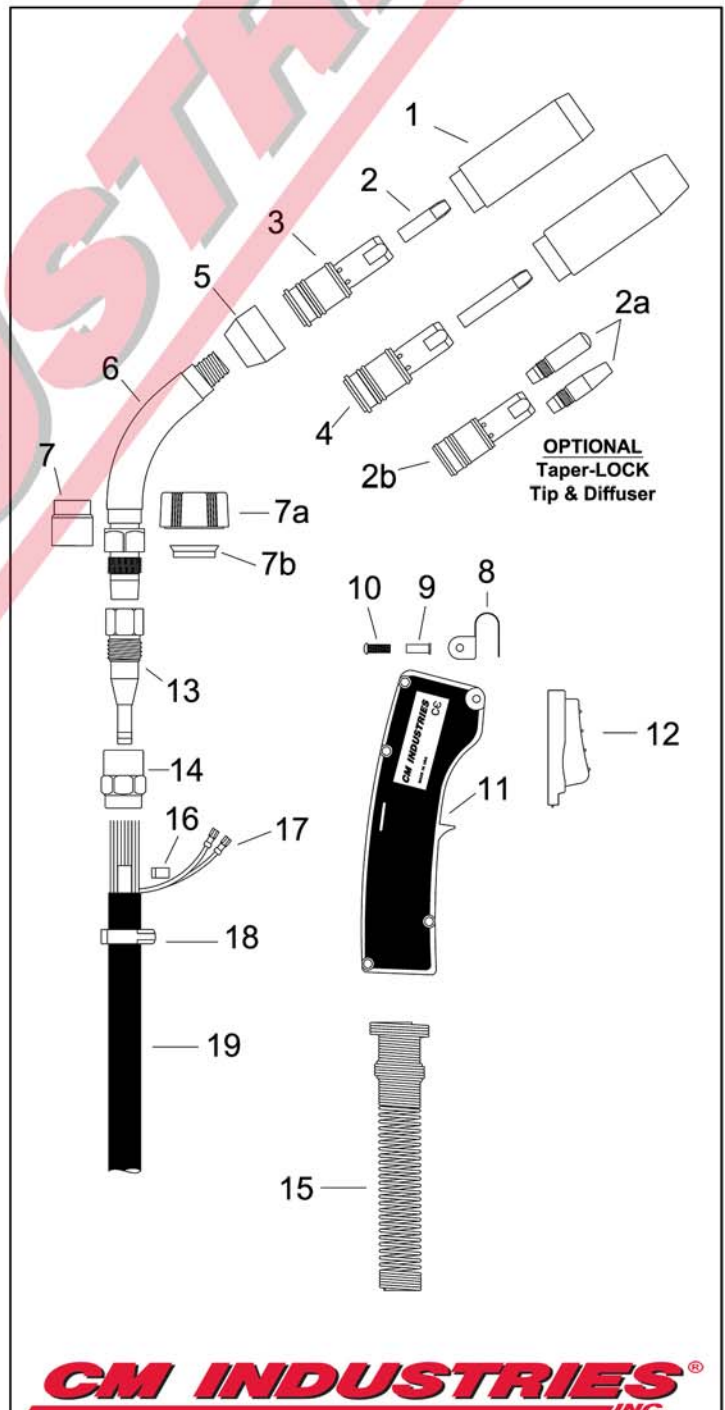

**CM INDUSTRIES INC.**

COPYRIGHT © 2014 CM INDUSTRIES, INC. ALL RIGHTS RESERVED

| #   | Part Number | Description                              |
|-----|-------------|--|
| 7.  | B4780       | Insulator Hex Nut                        |
| 7a. | B1840057    | Plastic Lock Nut                         |
| 7b. | B1840031    | Silicone Rubber Seal                     |
| 8.  | B4238       | Hang Up Hook                             |
| 9.  | B4207       | Post Fastener                            |
| 10. | B4209       | Handle Screw                             |
|     | B1880004    | Screw/Post Kit                           |
| 11. | B1880198    | Handle Kit w/ Screws                     |
| 12. | B5662       | Trigger Assembly                         |
| 13. | B4313B      | End Fitting                              |
| 14. | B4305       | Cone Nut                                 |
| 15. | B2520042    | Handle Spring                            |
| 16. | B4991       | Clamp, Conduit                           |
| 17. | B2660001    | Trigger Terminal                         |
| 18. | B4823       | Clamp, Jacket                            |
| 19. | B1060109    | Cable Assembly, 10'                      |
|     | B1060110    | Cable Assembly, 12'                      |
|     | B1060111    | Cable Assembly, 15'                      |
|     | B1060112    | Cable Assembly, 20'                      |
|     | B1060113    | Cable Assembly, 25'                      |
| 20. | B2520041-S  | Strain Relief Spring                     |
| 21. | B2520066    | Strain Relief Kit                        |
| 22. | B2280056    | Screw                                    |
| 23. | BGN2021     | Electrical Plug, Miller                  |
| 24. | B4719       | Electrical Plug, Lincoln                 |
| 25. | B1010027    | Adaptor Block                            |
| 26. | B2200101    | Power Pin, Miller                        |
| 27. | B4477       | Power Pin Tip, Miller .023" - .045"      |
|     | B4477-564   | Power Pin Tip, Miller .052" - 5/64"      |
| 28. | B4478       | O-Ring, Miller                           |
| 29. | B2200118    | Power Pin, Tweco 4                       |
| 30. | B4713       | O-Ring, Tweco 4                          |
| 31. | B2200099    | Power Pin, Lincoln "LN"                  |
| 32. | B4816       | Euro Connector Nut                       |
| 33. | B5060       | Euro Connector Plug                      |
| 34. | B4421       | O-Ring, Euro                             |
| 35. | B2520041-S  | Strain Relief Spring                     |
| 36. | B1880074    | Rigid Strain Relief Kit                  |
| 37. | B4925       | Locking Sleeve                           |
| 38. | B4901       | Quick Connect Body                       |
| 39. | B4924       | Lead Wire                                |
| 40. | B4919       | Gas Pin Assembly                         |
| 41. | B4916       | Wave Spring                              |
| 42. | B4912       | Snap Ring, Small                         |
| 43. | B4911       | Snap Ring, Large                         |
| 44. | B2200008    | Power Pin, Bernard EZ                    |
|     | B1199       | Bernard Quick Disconnect Kit (37-44)     |
| 45. | B1983Q      | 300A Rear Cone Nut Repair Kit            |
| 46. | B44115      | Liner Assembly, 15', .035"-.045"         |
|     | B44125      | Liner Assembly, 25', .035"-.045"         |
|     | B44215      | Liner Assembly, 15', .045"-.062"         |
|     | B44225      | Liner Assembly, 25', .045"-.062"         |
|     | B43115X     | Teflon Liner Assembly, 15', .035"- 3/64" |
|     | B44215X     | Teflon Liner Assembly, 15', .045"-.062"  |

