

MIGZONE ENDURANCE SERIES

MZ-E 550W

MIGZONE®
TORCHES100
%ED0,8
-
1,6
mm550
A_{CO2}500
A_{MIX}**i Neck Variations**

You can get our whole MZ-E series
MIG Torches with rotating necks.

**Complete Torch**

MZ-E 550W cpl. with grey handle,
Euro-connection (Steel Liner 2,0x4,5mm)

3m	MZ-550WAA3E
4m	MZ-550WAA4E
5m	MZ-550WAA5E

MIGZONE MZ-E Series – air and watercooled MIG-Torch

DIN Norm

Technical data according to CE EN 60 974-7

The Handle

2-component handle - robust and ergonomic

The Trigger

U/D Module (Option)

The Gun and Cable

Premium components installed

MIGZONE MZ-E 550W – watercooled MIG-Torch

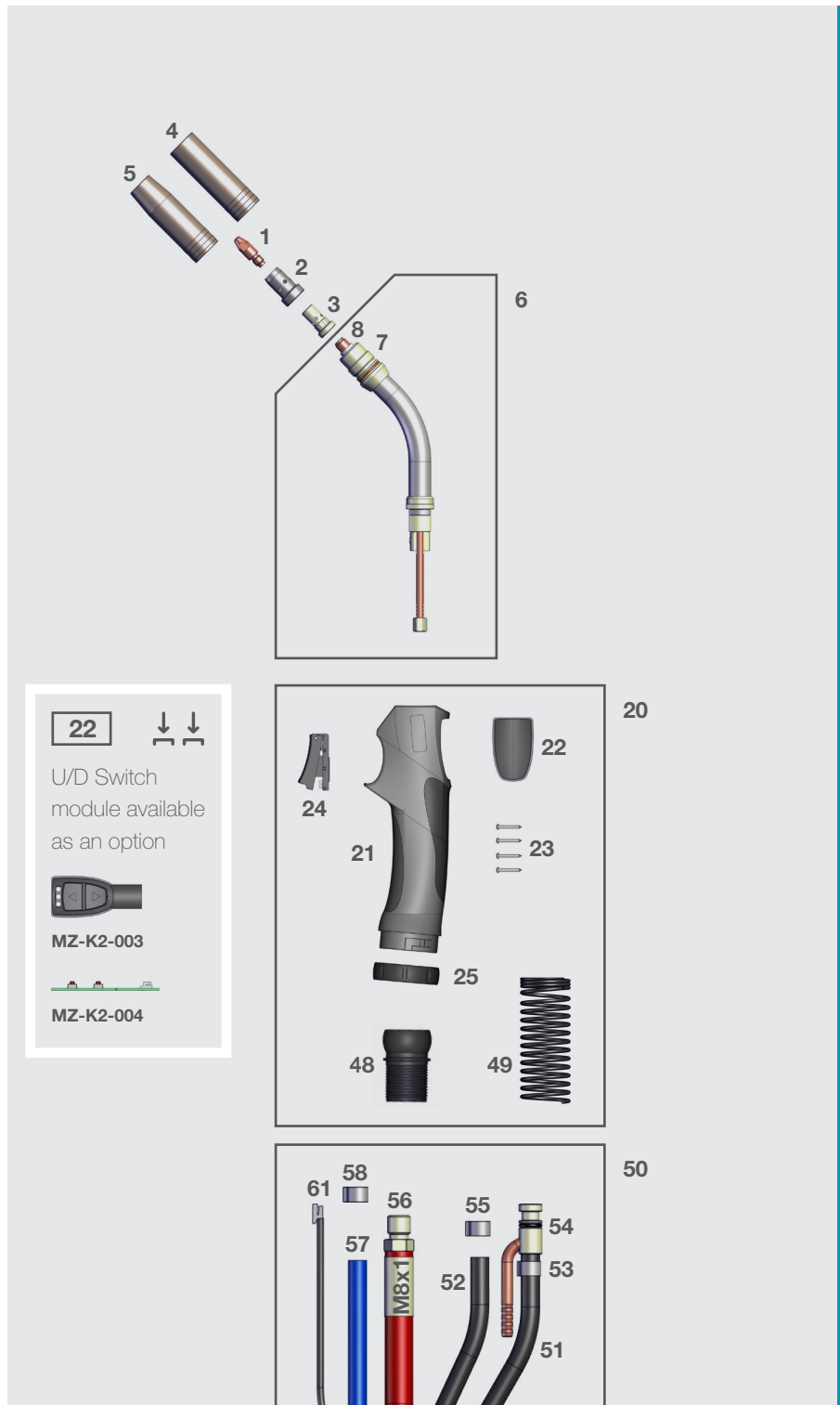

Complete Torch

MZ-E 550W cpl. with grey handle, Euro-connection (Steel Liner 2,0x4,0mm)

3m	MZ-550WAA3E
4m	MZ-550WAA4E
5m	MZ-550WAA5E

Torch Front Group

1 Contact Tip Pro	M6x28	M8x30
ECu	-	24106xx
CuCrZr	-	24176xx
for Alu	-	24166xx
Contact Tip Eco	M6x28	M8x30
ECu	-	24106xxL
CuCrZr	-	24176xxL

i Tips available in Ø 0,8/0,9/1,0/1,2/1,4/1,6 mm
Please insert wire diameter at **xx**.
Example Ø **1,0** mm is: 10; Art.-No.: = 2410610

2 Gas Diffuser		
white*		2410702
black		2410700
Gas Diffuser Heavy Duty		2410702K
eco		2410702L
3 Tip Adapter	M6	M8
short L=25mm	-	2410408
short CuCrZr	-	2410408C
long L=29mm	-	-
Gas Nozzle screw-on L=76mm		
4 cylinder NW20		20016003
5 conical NW16*		200160031
6 Swan Neck MZ-E 550W		
for screw-on Gas Nozzle		550WM100
7 O-Ring		
for Swan Neck		21201029
8 Insulating Washer		
Insulating Washer		2410203

Handle Group

20 MIG-Handle MZ-K2, grey	complete, watercooled	MZ-HDL-K2G-W
21 MIG-Handle MZ-K2, grey	left + right half	MZ-K2-001
22 Neutral top	MZ-K2	MZ-K2-002
23 Screw for	Handle	MZ-K2-005
24 Trigger cpl.	MZ-K2	MZ-K2-006
25 Nut for	Handle MZ-K2	MZ-K2-007

Cable Group

48 Gun Plug Housing	Swivel	MZ-K2-008
49 Spring	Cable Support	MZ-K2-010
	Single Ear Clamp	
53	D = 11,8	11.8GER
55	D = 8,7	08.7GER
58	D = 10,0	10.0GER
52 Gas Hose	Ø 4,0x1,5 (PU=100m)	0550111
54 Connector	Wire-Gas	21201027
57 Water Hose	blue Ø 5,0x1,5, (PU=200m)	CR05/8 BL

22 U/D Switch module available as an option

MZ-K2-003

MZ-K2-004

Cable Group

Part	3m	4m	5m
50 Cable Assembly MZ-E cpl.	24139M30	24139M40	24139M50
51 Outer Liner MZ-E cpl.	25146M30	25146M40	25146M50
56 Power Cable cpl.	2414130	2414140	2414150
61 Control Cable MZ-E cpl.	24144M30	24144M40	24144M50

* Parts marked with * are included in the standard configuration

MIGZONE MZ-E 550W – watercooled MIG-Torch

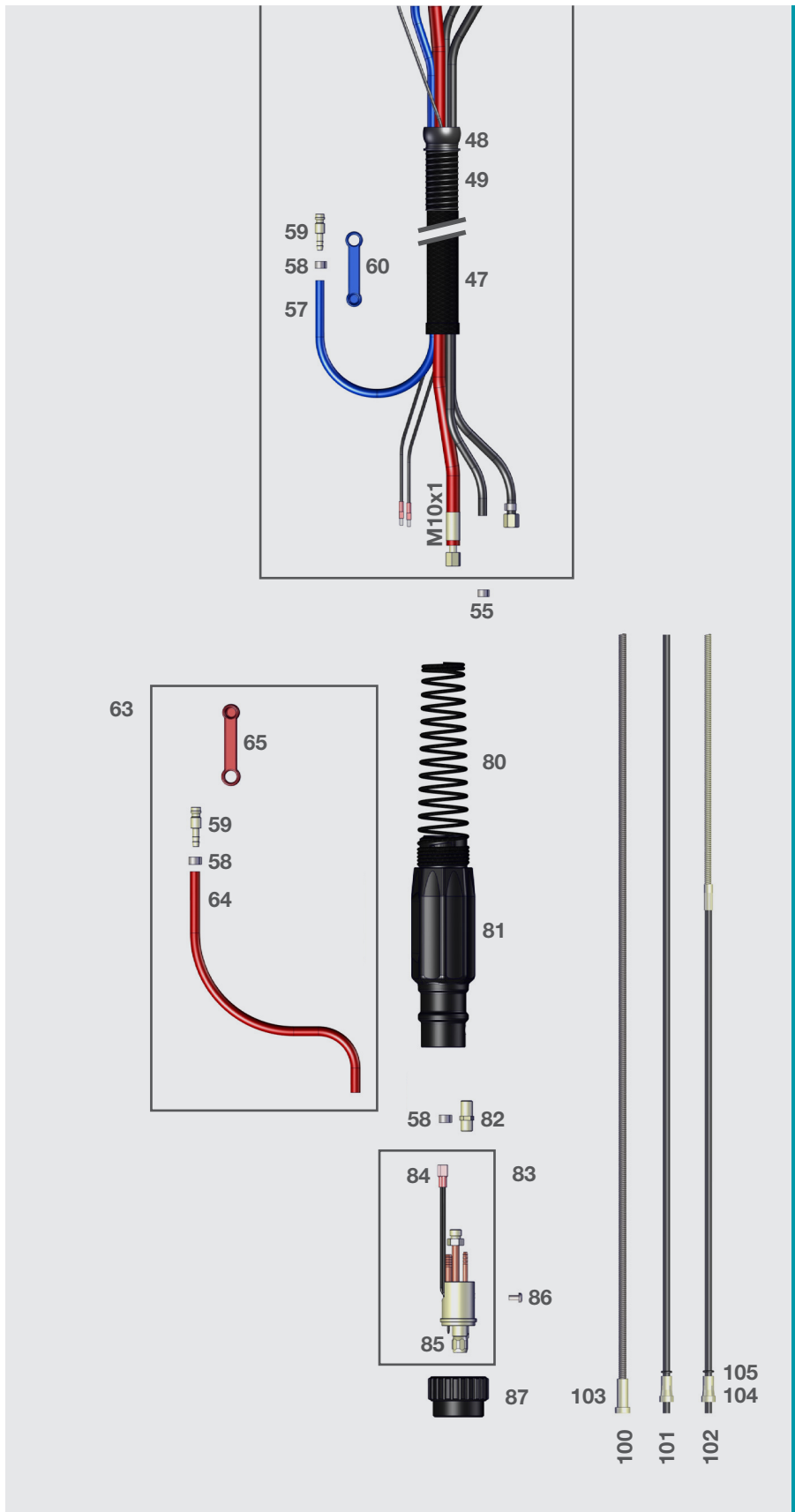

Cable Group		
47	Cover Hose MZ-E (PU=40m)	WS-2
48	Gun Plug Housing Swivel	MZ-K2-008
49	Spring Cable Support	MZ-K2-010
	Single Ear Clamp	
53	D = 11,8	11.8GER
55	D = 8,7	08.7GER
58	D = 10,0	10.0GER
59	Water Hose Nipple	T0535
	Water Stop	
60	blue	TZ-KAPPE-1
65	red	TZ-KAPPE-2
63	Water Outlet Hose cpl. 0,55m	2414705
64	Water Hose red Ø 5,0x1,5 (PU=200m)	CR05/8 RO
80	Cable Support Spring	2411611
81	Plug Housing without nut	2411600S1
82	Nipple Threaded	2411501
83	Gun Plug Body with Spring Loaded Pins	2411505
84	Female Electrical Connector insulated	2155100
	Nut	
85	Liner Positioner	2151501
87	Plug	ZA-14
86	Screw for Gun Plug Body	ZA-11
Liner Group 5		
100	Mono-Steel-Liner 2,0 x 4,5 mm / X m*	34520X1
	2,5 x 4,5 mm / X m	34525X1
101	Mono-Synthetic-Liner	
	PTFE 2,0 x 4,0 mm / X m red	34120X0
	PTFE 2,7 x 4,7 mm / X m yellow	34727X0
	Carbon-PTFE 2,0 x 4,0 mm / X m	35120X0
	Carbon-PTFE 2,7 x 4,7 mm / X m	35727X0
	PA 2,0 x 4,0 mm / X m	35220X0
	PA 2,3 x 4,7 mm / X m	35323X0
	PA 2,7 x 4,7 mm / X m	35327X0
102	Combi-Synthetic-Liner	
	PTFE 2,0 x 4,0 mm / X m red	34120X0K
	PTFE 2,7 x 4,7 mm / X m yellow	34727X0K
	Carbon-PTFE 2,0 x 4,0 mm / X m	35120X0K
	Carbon-PTFE 2,7 x 4,7 mm / X m	35727X0K
	PA 2,0 x 4,0 mm / X m	35320X0K
	PA 2,3 x 4,7 mm / X m	35323X0K
	PA 2,7 x 4,7 mm / X m	35327X0K
	Collet (Mono & Combi)	
103	for Steel-Liner Ø 4,5 mm	2155645
104	for Synthetic-Liner Ø 4,0 mm	2155740
104	for Synthetic-Liner Ø 4,7 mm	2415747
105	O-Ring for Synthetic and Combi Liner	0031500

i Liners available in 3 m / 4 m / 5 m length. Please insert length at **X**. Example: Steel-Liner 4 m = 3452041

***** Parts marked with * are included in the standard configuration